



www.EntraPASS.com / 8641 S. Warhawk Rd., Conifer, CO 80433 - Tel: 303-670-1099 - Email: Patrick.McAllister@EntraPASS.com

IP Network Audio-Video Intercom





The image is simulated.

Greater flexibility, covering more applications.

The IX System – getting the job done for a wide range of business applications, while achieving connection and integration with third-party IP systems.

Full IP-based Audio-Video Intercom System

Enables to communicate between an infinite number of door/master stations with no distance limitations. Helps save money as no server is required to build a system.

Integration with other IP-based security systems

Using an existing IP infrastructure, IX System can be integrated with Video Management System, Access Control System, and Network Camera System, etc. Combining security components saves time and resources during set-up and training.

24/7 Monitoring/Recording

Video from door station can be monitored and recorded via third-party VMS/NVR systems. Enhances security level for various applications.

Aiphone offers the ideal intercom system for a diverse range of applications that leverage your IP network.



Offices



Airports



Railways



Parking facilities



Hospitals



Factories



Prisons



Shopping Malls



Schools

Broad coverage through network connections.

Full IP-network compatibility, simple installation, and greater flexibility.

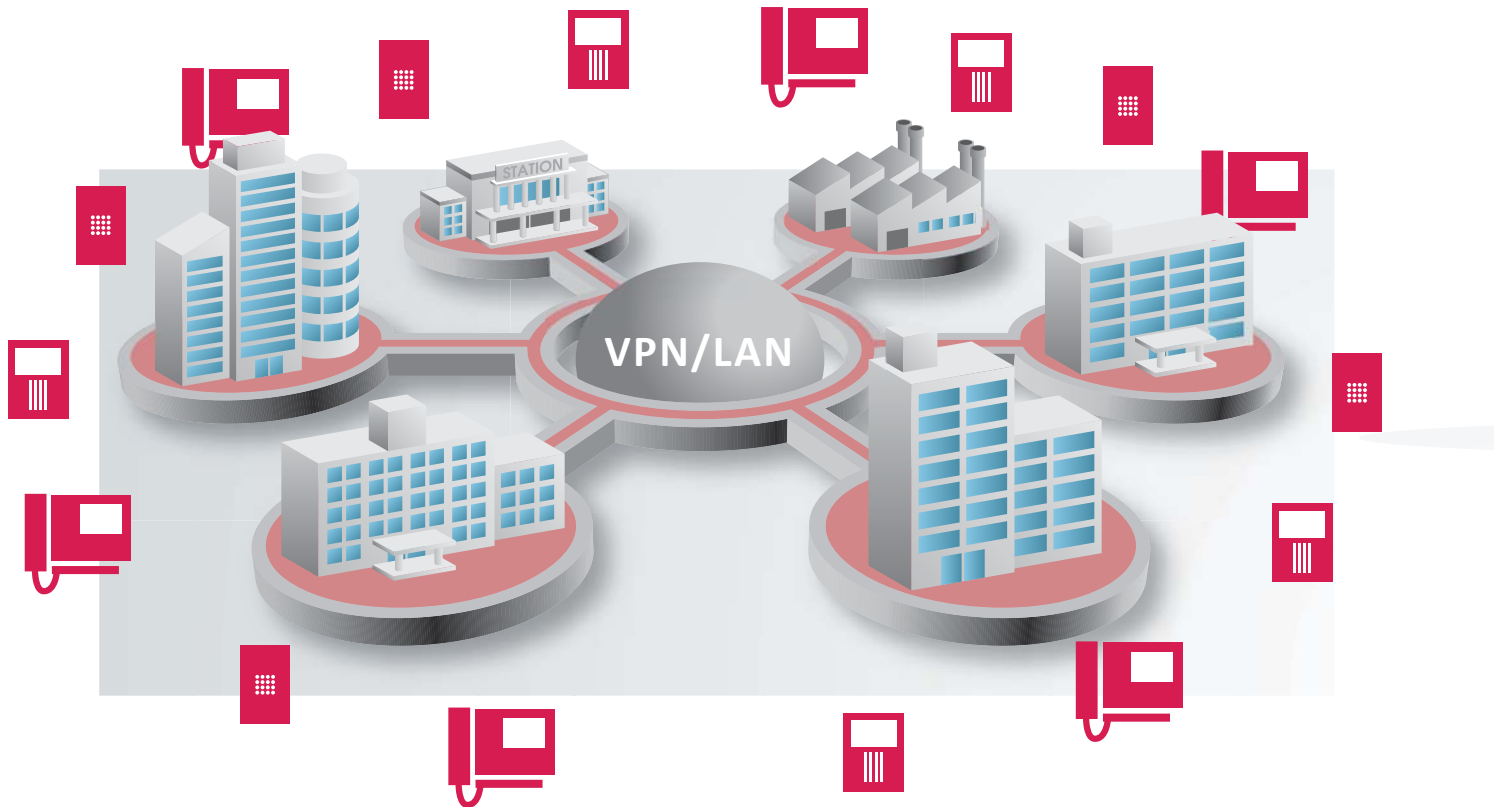

Unlimited number of devices

IP addresses for up to 500 devices can be registered for each master station – plenty of coverage even in large-scale applications.



No wiring-distance limitations

LAN and VPN connections enable implementation over extensive areas and between remote locations. This system allows for closed circuit communication and central control in large facilities, between corporate and satellite offices, and any type of application with multiple locations.

No server configuration results in space savings, reduced installation time, and lower cost

Simply connect the units to Power over Ethernet (PoE) switches. This means no need for a dedicated server, with the additional benefit of eliminating the risk of system downtime due to server malfunction.



PoE design

Electrical power is supplied over the LAN port connection.



New generation of intercom with flexible integratability.

Security enhanced Integration



Compatible with third-party systems

This system is compatible with the ONVIF Profile S-established interface specifications for network camera equipment. This allows the intercom to be used with third-party systems, enabling interoperability of integrated IP systems. The open API allows for configuring IP systems with greater flexibility.



Examples of Integration

Use with a Video Management System and Access Control

Interconnection with an ONVIF Profile S-compatible network camera system lets you transform door station into surveillance cameras for facial identification of visitors. Integrate with video management systems for 24/7 recording. Integration with third-party access control is also possible.

*VMS (video management system): XProtect® by Milestone Systems

*Access control: OnGuard® by Lenel



Clearly identify visitors with both the intercom and Network camera.

Custom settings for a variety of

Call Queuing

Master stations can receive up to 20 incoming calls simultaneously. Caller information can be displayed on a call queue list, making it possible to respond selectively to high-priority calls.

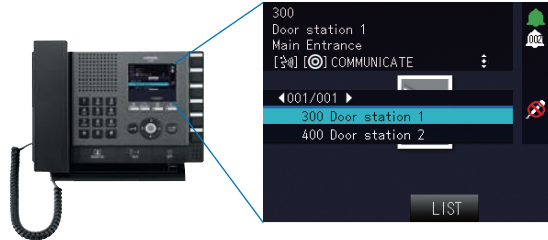

Unicast / Multicast

According to an infrastructure, there is a choice of sending data via Unicast or Multicast. Paging to all stations can be done using Multicast, and for Unicast communication, paging up to 50 stations is possible.

Customize with prerecorded messages

Create and import custom audio files for use as unique voice messages. For visitors at door stations, voice messages let them know that door is open.



For security guards/receptions at master stations, voice messages help them to identify incoming calls instantly.

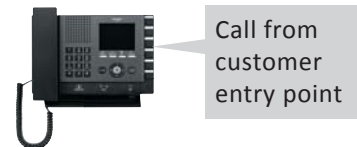

Page to all stations or individual groups

Page to all stations and page to preset specific groups is possible. A third-party paging amplifier can be connected for additional coverage.

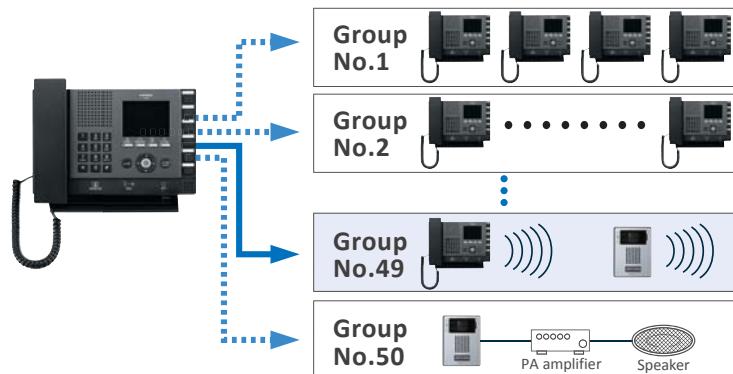

Send E-mail

When master stations are called, IX System can send an E-mail attached with the visitor's picture up to 3 E-mail addresses. Error in the system and health check report can be also sent via E-mail.

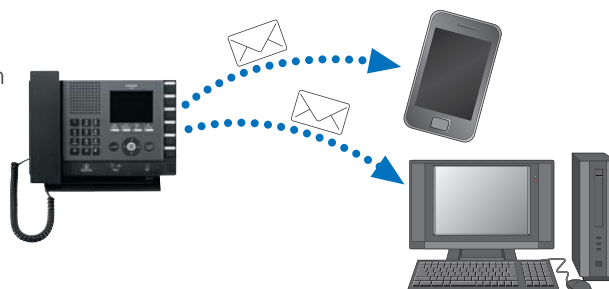

features.

A wide array of call transfer features

The system offers an array of call transfer features that can be set to meet the application.

Manual transfer

A call from a door station can be placed on hold and transferred to another master station manually by the user.

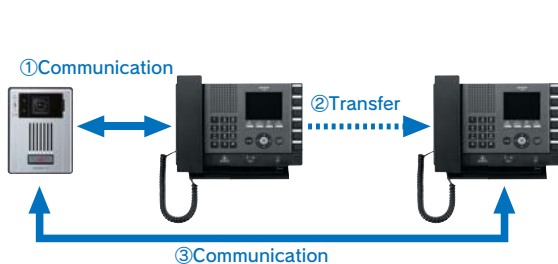

Delay transfer

If no response occurs within a set interval, call is automatically transferred to a pre-programmed master station.



Absent transfer

Call is automatically transferred to a different master station immediately.

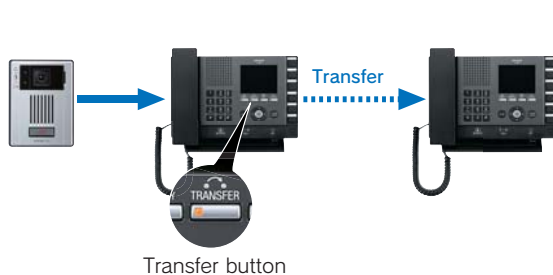

Schedule transfer

Call is automatically transferred to a preset master station during scheduled times, such as after normal business hours.

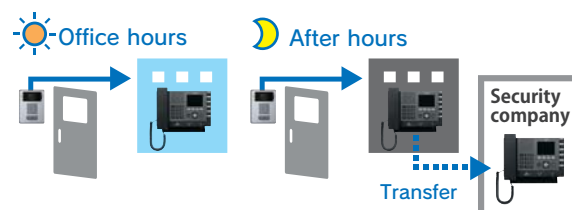

Usage-specific individual calls and simultaneous calls to multiple devices

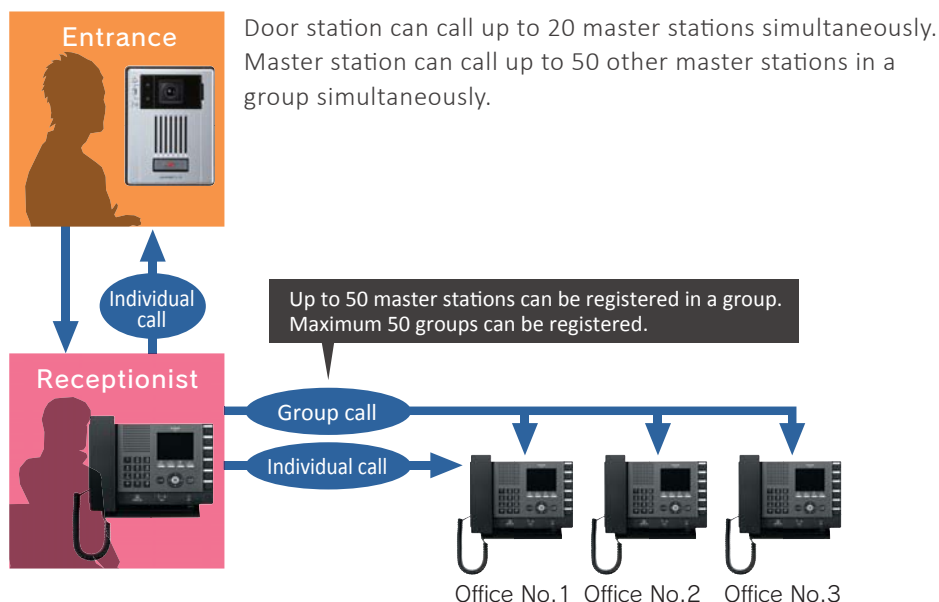

Airports: Examples of Popular Applications

All-in-one system for Internal communication, Access Control for restricted area, and Video surveillance.

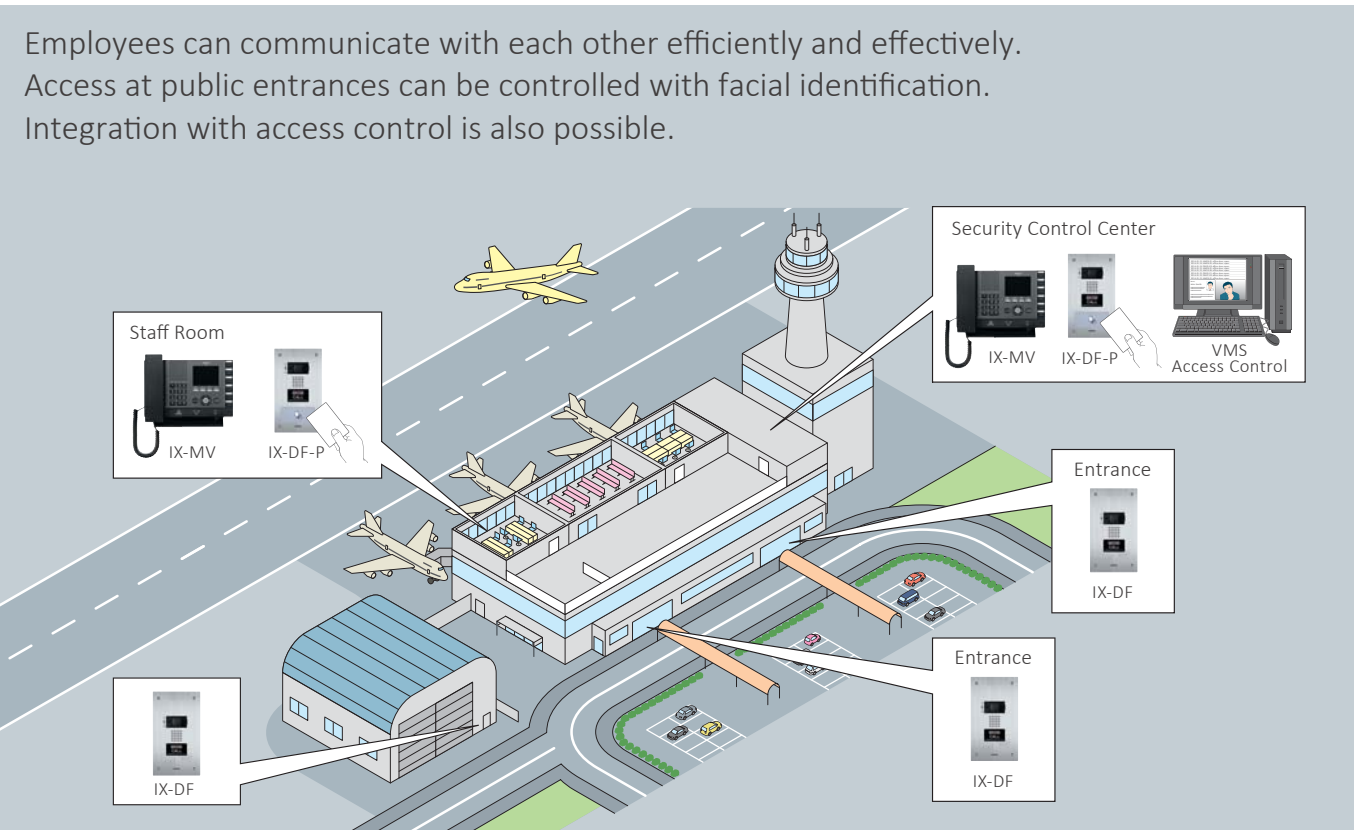

Railways

All-in-one system for Help points, Communication between distant stations, and Video surveillance.

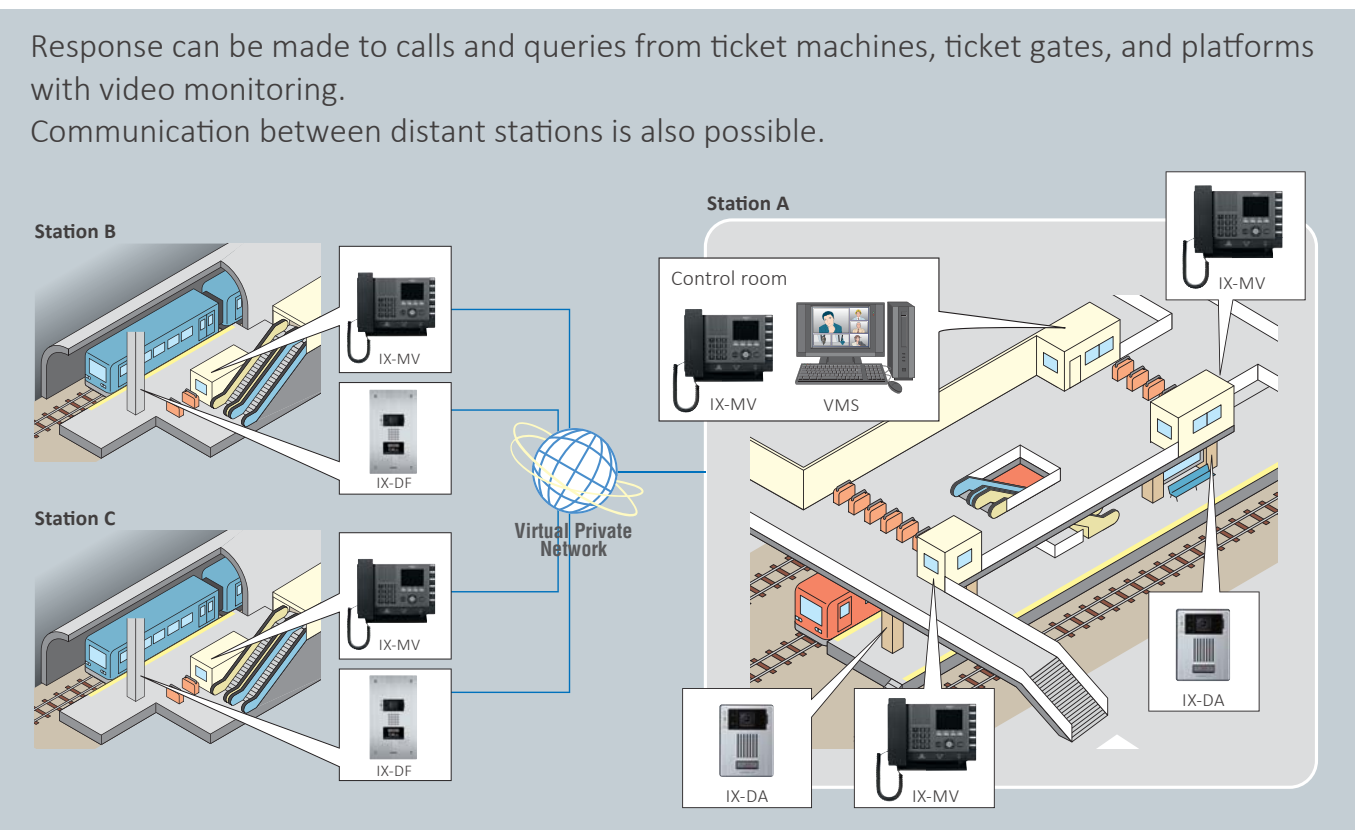

Schools

All-in-one system for Door Entry management, Call transfer for after hours, and Emergency paging.

Management of entry and exit points integrated with access control can be accomplished. The system can also be used to enable teachers and staff members to easily communicate with one another. After hours control for schools within the district can be performed at a central control site.

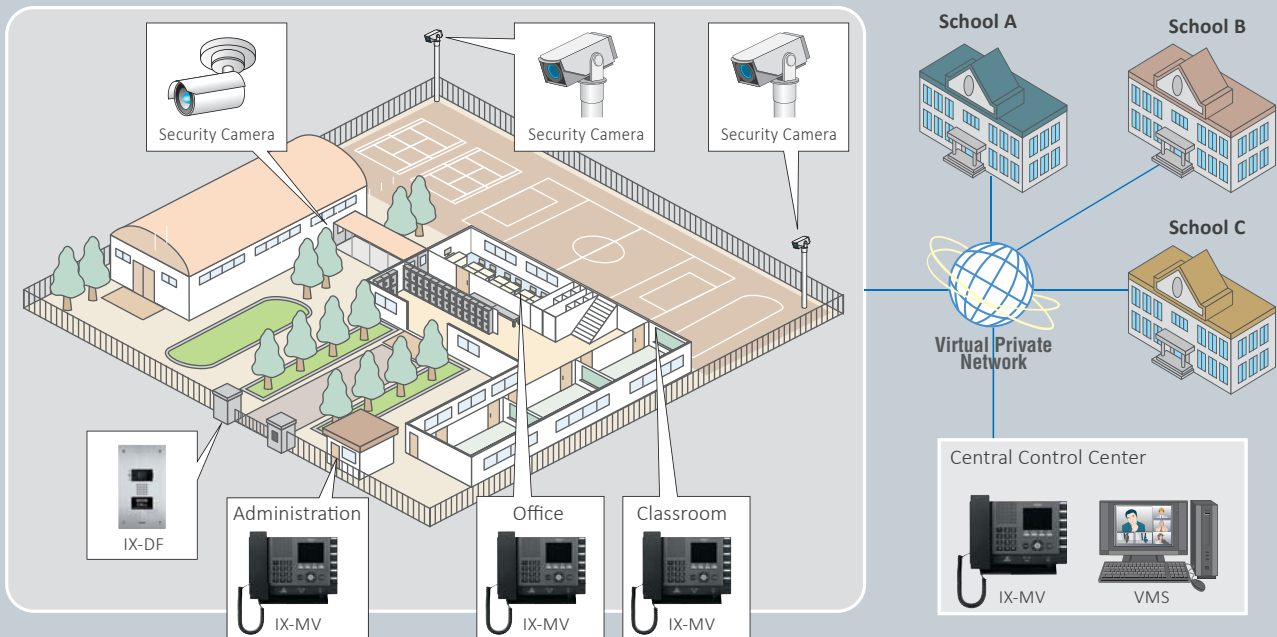

Parking facilities

All-in-one system for Emergency call, Remote control of distant parkings, and Video surveillance.

Audio communication and video identification allows for immediate where assistance is needed. Crime prevention can be enhanced further through simultaneous installation of network cameras.

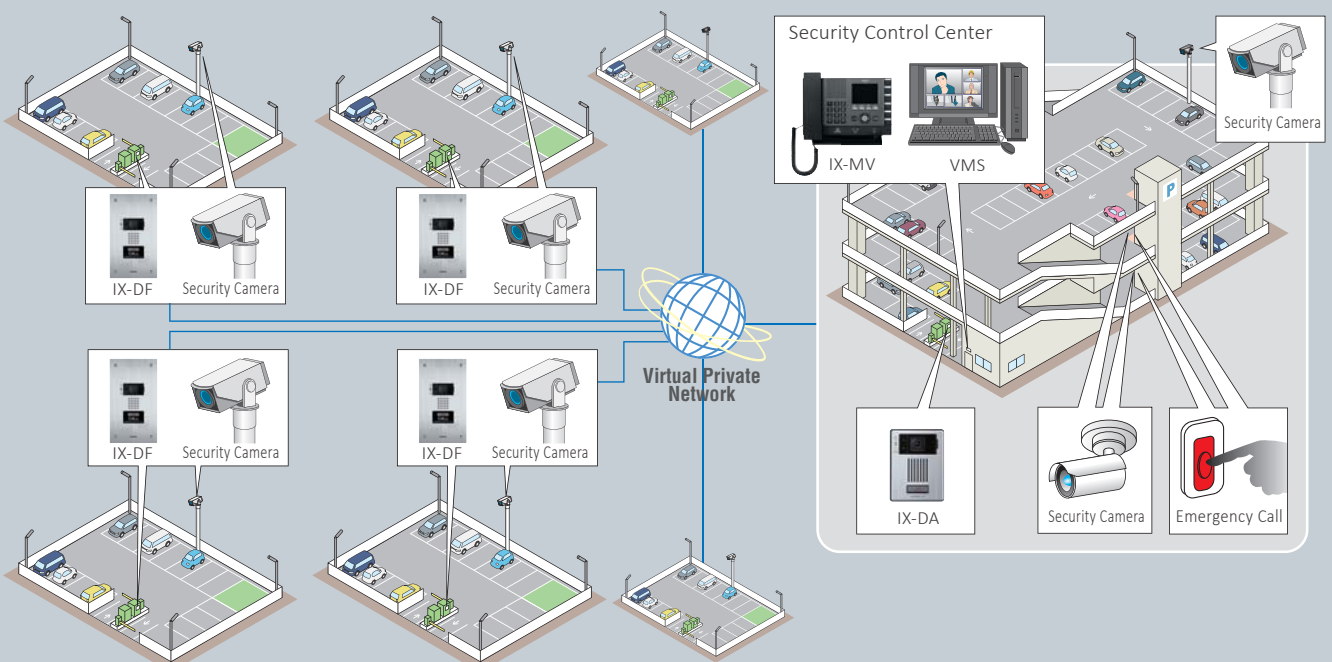

Flexible system configuration to meet your specific application

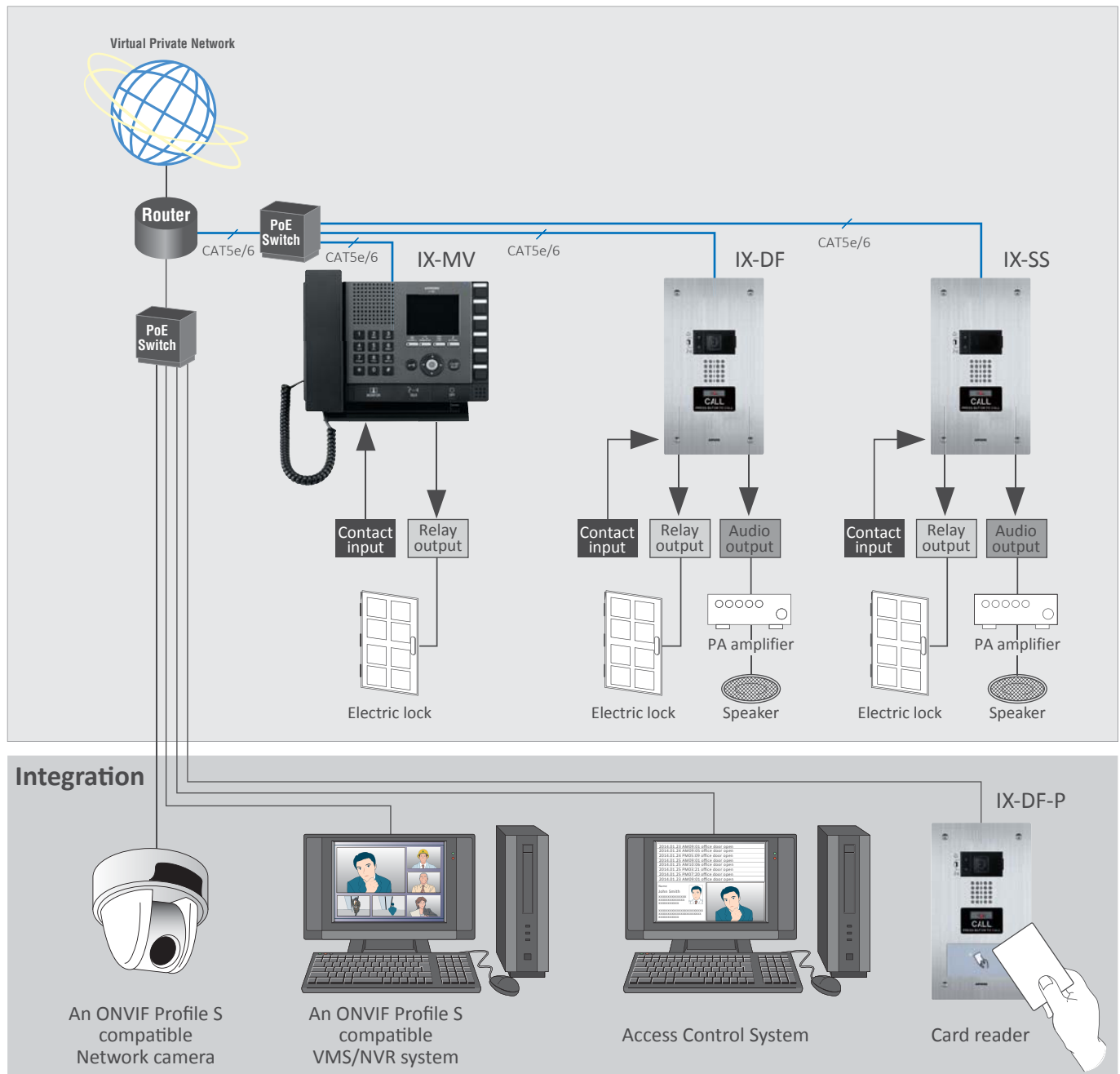

A Guide to Terms

ONVIF (Open Network Video Interface Forum)

The interface specifications established by ONVIF provide standards that enable exchange of live video and audio as well as control information and the like by surveillance cameras and other network video devices feed, even among products from different manufacturers.

VMS (Video Management Software [or "System"])

This refers to video management software using an IP network. Servers and cameras of any make can be installed, enabling configuration of systems matched to user needs.

NVR (Network Video Recorder)

This is a device that records video feed from a network camera over an IP network.

Open API

This refers to a publicly disclosed set of commands and functions that can be used in programming. It enables control of intercom functioning by user programs, and also makes it possible for user programs to acquire information from intercoms.

Master Station



●IX-MV

IP Direct Audio + Video Master Station

- 3.5 inch LCD display
- Handset or hands-free
- Door release
- PoE - 802.3af
- Desk stand included (also wall mountable)
- Input/Output : Contact input X 1
Relay output X 1

Video Door Station



●IX-DF

IP Direct Audio + Video Door Station

- Stainless steel
- PoE - 802.3af
- Flush mount
- Mounting box included
- Input/Output : Contact input X 1
Relay output X 1
Audio output X 1

Audio Only Door Station



●IX-SS

IP Direct Audio Door Station

- Stainless steel
- PoE - 802.3af
- Flush mount
- Mounting box included
- Input/Output : Contact input X 1
Relay output X 1
Audio output X 1

Video Door Station



●IX-DF-P

IP Direct Audio + Video Door Station for ProxPoint® Reader

- Same features as IX-DF
- Compatible with HID® ProxPoint® Plus Proximity Card Reader
- Input/Output : Contact input X 1
Relay output X 1
Audio output X 1

* Card reader not included

Video Door Station



●IX-DF-PI

IP Direct Audio + Video Door Station for iCLASS® Reader

- Same features as IX-DF
- Compatible with HID® iCLASS® Smart Card Reader
- Input/Output : Contact input X 1
Relay output X 1
Audio output X 1

* Card reader not included

Video Door Station



●IX-DA

IP Direct Audio + Video Door Station

- Fire-retardant resin
- PoE - 802.3af
- Surface mount
- Input/Output : Contact input X 1
Relay output X 1
Audio output X 1

Audio Only Door Station



●IX-BA

IP Direct Audio Door Station

- Fire-retardant resin
- PoE - 802.3af
- Surface mount
- Input/Output : Contact input X 1
Relay output X 1
Audio output X 1

Specifications

- LAN : Ethernet (10BASE-T, 100BASE-TX)
- Audio Codec : G.711
- Video Codec : H.264/AVC, Motion-JPEG (Master Station, Video Door Station only)
- Network protocol : IPv4, IPv6, TCP, UDP, SIP, HTTP, HTTPS, RTSP, RTP, RTCP, IGMP, MLD, SMTP, FTP, DHCP, NTP, DNS
- Authentication : SSL3.0, TLS1.0, TLS1.1, TLS1.2
- Packet communication method : Unicast, Multicast (Multicast : Master Station, Video Door Station only)
- Other : ONVIF profile S (Master Station, Video Door Station only)

UNIT DIMENSIONS(mm)

IX-MV

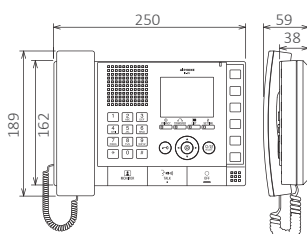

IX-DF

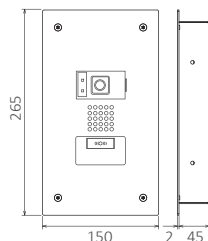

IX-SS

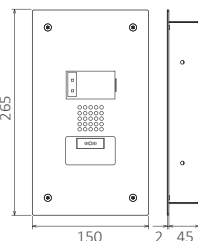

IX-DF-P, IX-DF-PI

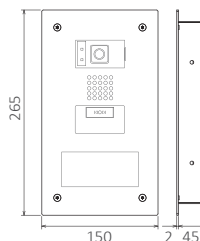

IX-DA

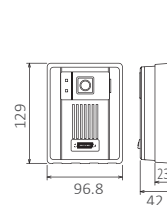

IX-BA

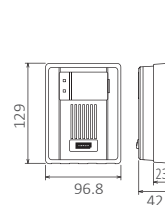

IP Addressable Intercoms & Emergency Stations



**EXPAND SECURITY AND COMMUNICATION ALONG YOUR
NETWORK**

ROBUST SYSTEM FEATURES

Great new features make the IX Series one of the most powerful intercom systems in the security industry.



MOBILE APP FOR CELL PHONES & TABLETS

Identify visitors, unlock doors, make announcements, answer pages, and talk between stations from a smart phone or tablet. IX Mobile is available on Google Play™ and the App Store™.



PRIORITY CALL QUEUING

Emergency Stations can jump to the front of the call queue. Calls can be set to three different priority levels to make sure people get assistance quickly.



EMERGENCY STATIONS

The IX Series features three different Emergency Stations to choose from. Install them in Aiphone towers and wall boxes.



LARGE CAPACITY ADDRESS BOOK

Each IX-MV master station can store up to 500 unique or shared station addresses. System size can be expanded infinitely by adding more master stations.



VIDEO INTEGRATION



24/7 VIDEO STREAMING



Each IX Series video station can stream live to a video management system.



CCTV INTEGRATION

Easily view video from third party ONVIF Profile S cameras on the IX-MV master station screen.

Network Friendly

- The IX Series offers both unicast and multicast capability for more flexible deployment in a variety of network infrastructures.
- IX Series stations are network direct devices and powered using 802.3af compliant PoE.



Improved Audio

- Volume levels at exterior stations measure 82.7dB at 30cm, the loudest Aiphone video intercom on the market.
- Connect door or emergency stations to amplified speakers for additional volume.



Call to one another directly over a network. Verify guests, unlock doors, and assess emergency situations from anywhere on a network.



EDUCATIONAL / CORPORATE CAMPUSES

Aiphone intercoms have been securing entrances for over 40 years. Now, we use our award winning technology to help make the outdoors just as safe as the indoors. Retrofit existing towers or install Aiphone Modular Towers and Emergency Stations across campuses.



INSTITUTIONAL FACILITIES

Hospitals, correctional facilities, and other institutions can benefit from centralized security. Manage entry ways, hallways, sally ports, parking garages, and visiting areas. The IX Series incorporates emergency stations and communication stations over a network to ensure safety for visitors and employees.



PARKING GARAGES / AREAS

The IX Series' audio output make exterior stations ideal for higher volume areas. Easily assist visitors at facilities remotely with clear communication. Combined with Emergency Stations, the IX Series blends communication with emergency preparedness.



RESIDENTIAL HOMES

Use a reliable router or WiFi access point to connect an IX Series station wirelessly to a network. Identify visitors from inside or from any location miles away. For individuals with multiple properties, install the IX Series to communicate quickly between residences.

Programmed Alerts

Automatic intercom call-in to security following failed card swipe

Video + Audio Streaming

Monitor activity at IX Series video stations on an OnGuard display

Intercom Station Status

Perform system health checks and easily identify offline stations
View which stations are idle, queued, or in communication

Event logging

Review station event history
Review error logs

Start with an IX-MV master station and network an infinite number of IX Series stations. Adding more master stations exponentially increases system capacity as each master station can call up to 500 unique or shared stations.





Master Station



IX-MV*

Video Master Station

- PoE
- 500 station address book capacity
- Hands-free communication with handset for privacy
- Wall or desk mount

Sub Master Station



IX Mobile

(Android® 4.1 or above and Apple® iOS 8.0 or above)

Mobile Device Sub Master Station

- Identify visitors and unlock doors
- 4 programmable speed dials
- Requires purchase of IX-MV and RY-IP44
- Available on Google Play™ and the App Store™

Video Stations



IX-DA

Video Door Station

- PoE
- Fixed camera
- Plastic cover
- Surface mount
- Relay output



IX-DF

Video Door Station

- PoE
- Fixed camera
- Stainless steel
- Flush mount, back box included
- Relay output



IX-DF-HID

Card Access Video Door Station

- PoE
- Fixed camera
- Stainless steel
- Flush mount, back box included
- HID® ProxPoint® Plus Proximity Card Reader with Wiegand output
- Relay output



IX-DF-RP10

Card Access Video Door Station

- PoE
- Fixed camera
- Stainless steel
- Flush mount, back box included
- HID® multiCLASS SE® Smart Card Reader with Wiegand output
- Relay output

Audio Stations



IX-BA

Audio Door Station

- PoE
- Plastic cover
- Surface mount
- Relay output



IX-SS

Audio Door Station

- PoE
- Stainless steel
- Flush mount, back box included
- Relay output

Adaptors



RY-IP44

IP Addressable Input/Output Adaptor (Requires PS-1225UL)

- Four contact inputs
- Four programmable relay outputs
- Programmed via web browser
- Each RY-IP44 supports 8 IX Mobile apps

Network Adaptors

Connects LE Series and NE Series door/sub stations to an IX-MV master station and IX Mobile app.

Upgrade legacy systems!

- 2-wires
- PoE
- Built-in door release and camera call-up
- Form C dry contacts

IX-1AS

- Supports 1 LE/NE Series door/sub station

IX-10AS

- Supports up to 10 LE/NE Series door/sub stations



For IX Series surface mount boxes and accessories, visit www.aiphone.com/ix

ADA Compliant Emergency Stations

- PoE
- Fixed camera
- Lettering and Braille signage
- LED call status indicator
- 3 Form-C relay outputs
- Stainless steel
- Flush mount
- Back box included



IX-DF-2RA

Video Emergency Station

- Dual call buttons



IX-SS-2RA

Audio Only Emergency Station

- Dual call buttons



IX-SS-RA

Audio Only Emergency Station

- Single call button

