

PRO CAPTURE -WP

PRO SERIES

IP65 rated outdoor weather-proof
fingerprint access control reader

ProCapture-WP is a next-generation IP65-rated outdoor weather-proof access control reader utilizing advanced SilkID fingerprint sensor technology.



Biometric Preference

Reliable, durable and highly accurate SilkID fingerprint sensor with latest fingerprint matching algorithm which provides less than 1.5 second user recognition.



Display/Audio

Works without a computer. Complete setup and programming can be done via the ProCapture-WP keypad and embedded firmware. Audio-Visual Indication for acceptance and rejection of valid/invalid fingerprints, cards and passwords.



Capacity

Stores up to 20,000 fingerprint templates and 10,000 cards. Data can be backed up to a USB flash drive and transferred to another ProCapture-WP in the absence of network connectivity.



Full Access Control Built-In

Relay outputs for electric lock and alarm. Inputs for door status sensor and request to exit hardware. Supports multiple time zones and personnel groups for programming valid entry zones.



Communication

Weigand output for connecting to an access control panel and ethernet port for fast and reliable network communication. Optional Wi-Fi available.



For Software Developers

Free SDK and development tools are available for developers/partners who wish to integrate MB700-ID with any application which requires verifying people. Custom development is also available for OEM partners upon request.



Options

ProCapture-WP can be configured with optional internal modules which read HID Pros, HID iClass, or 13.56 MHz

CONFIGURATION

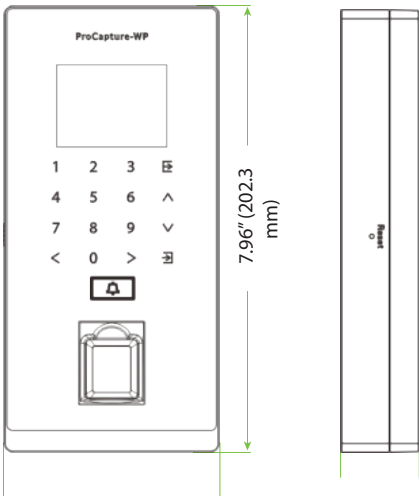
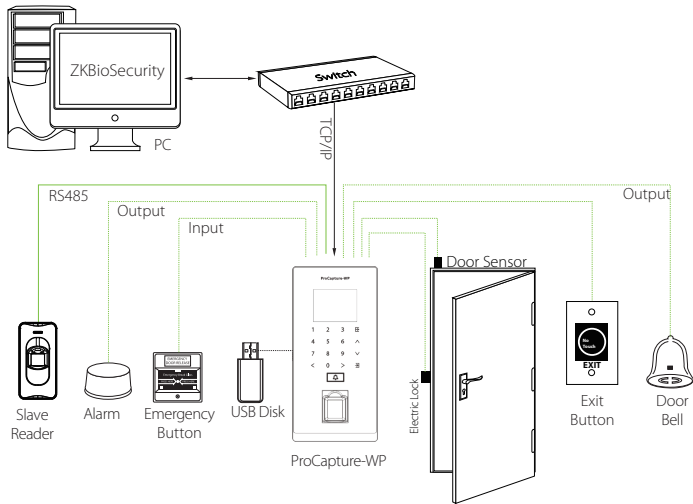

SPECIFICATIONS

Capacity:

Fingerprint: 20,000
Cards: 10,000

Access Control Interface:

Lock relay output, alarm output/
auxiliary input, exit button/door
sensor, doorbell output

Communication:

TCP/IP, RS485 (for slave readers)
Weigand input/output, USB host

Hardware:

SilkID fingerprint sensor, 2.4 in
TFT-LCD touch screen, 125 kHz
ZKAccess card reader tamper
switch alarm

Standard Functions:

Access levels/groups/holidays,
DST/bell schedule, Duress mode
(password), anti-pass backrecord
query, custom wallpaper & screen
saver

Software Compatibility:

ZKBioSecurity

Additional Info:

Working Temperature: 14 F - 122 F
Dimensions: 8 in x 3.5 in x 1in
Package Includes: 12V 3A power
supply

Power:

Operating Voltage: 12V DC
Current Draw: < 500mA

Part Numbers:

ProCapture - WP
ProCapture - WP - HID
ProCapture - WP - iClass

WHAT'S IN THE BOX:

