

\* DIMENSIONS MAY VARY SLIGHTLY IN ACTUAL INSTALLATION - FABRICATION CHANGES OR EQUIPMENT SUBSTITUTIONS RESERVED \*

# TC-E North East

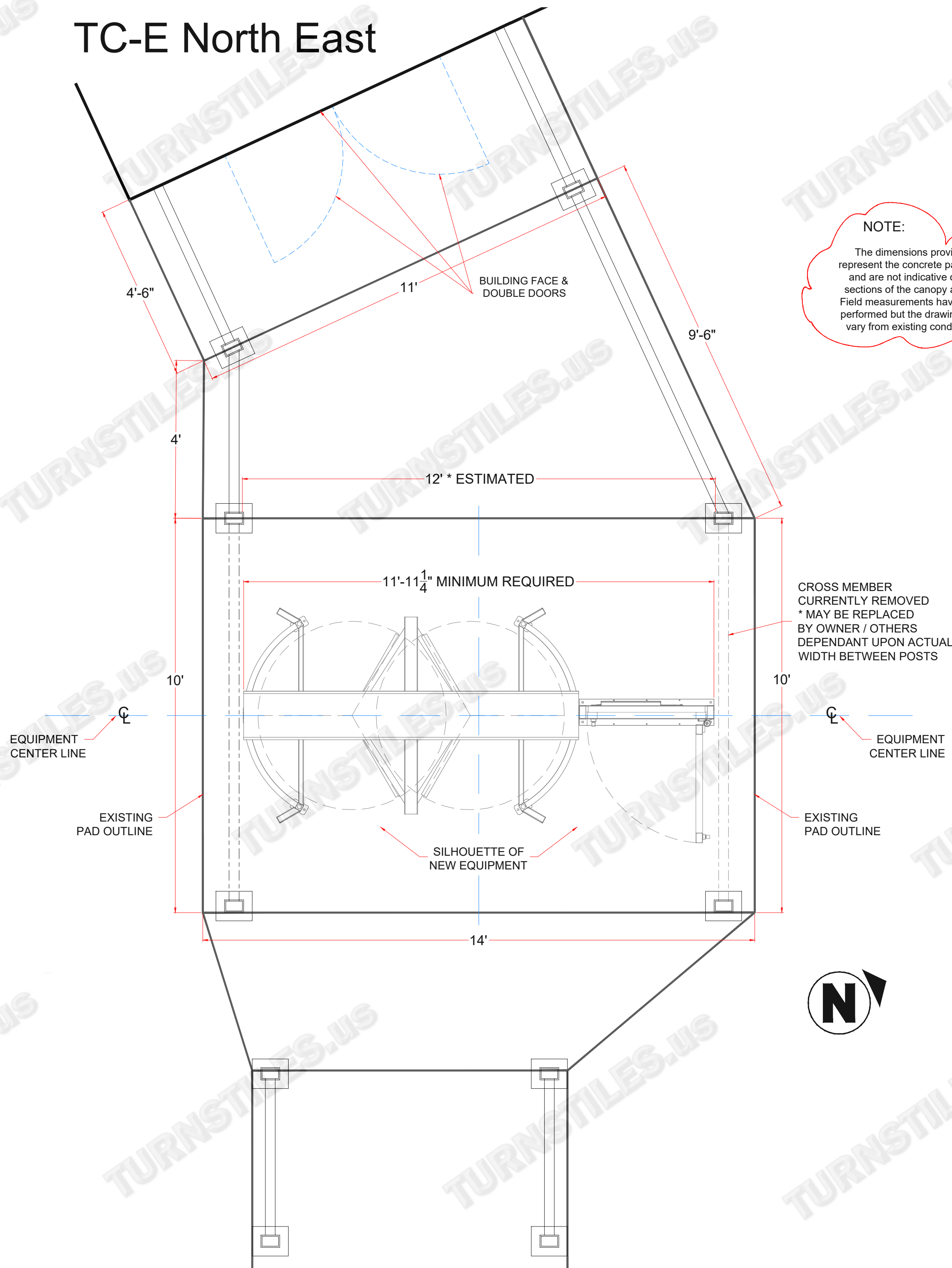

**NOTE:**  
The dimensions provided represent the concrete pad area and are not indicative of the sections of the canopy above. Field measurements have been performed but the drawing may vary from existing conditions.

FIRST DRAWN	BY
02-17-24	CJC
REVISED	BY
02-23-24	CJC

**COPYRIGHT © TURNSTILES.US**  
Copyright © Turnstiles.us All rights reserved. Reproduction or translation of this work without the express written permission of TURNSTILES.US is unlawful and is an infringement of intellectual property belonging to TURNSTILES.US. All drawings and/or designs are restricted for use exclusively with a purchase, installation, and/or support from Turnstiles.us. Any other use of these materials is a violation of copyright law. Request for additional information should be addressed to the Legal Department, Turnstiles.us.

**TURNSTILES.US**  
www.TURNSTILES.US  
Call 303 670 1099 \* Text 303 918 9787  
patrick.mcallister@turnstiles.us

CANOPY PAD DETAIL	
Caterpillar Technical Center Mossville, IL - Shannon Popp TC-E-West Entrance Existing Canopy Re-fit AG Series Tandem Turnstile & Swing Gate	
DWG	CATERPILLAR TC-E WEST - AG SERIES RE-FIT - ELD
DATE	02-23-24
SHEET - 1 OF 1	

AUTHORIZED SIGNATURE: \_\_\_\_\_ DATE: \_\_\_ / \_\_\_ / \_\_\_