

1

2

3

4

FIRST DRAWN	BY
07-24-25	CJC
REVISED	BY

COPYRIGHT © TURNSTILES.US
Copyright © Turnstiles.us All rights reserved. Reproduction or translation of this work without the express written permission of TURNSTILES.US is unlawful and is an infringement of intellectual property belonging to TURNSTILES.US.
All drawings and/or designs are restricted for use exclusively with a purchase, installation, and/or support from Turnstiles.us. Any other use of these materials is a violation of copyright law. Request for additional information should be addressed to the Legal Department, Turnstiles.us.

**TURNSTILES.US**
SECURING THE USA and the GLOBE since 1989
www.turnstiles.us
Call: 303-670-1099 | Text: 303-918-9787
patrick.mcallister@turnstiles.us

CONDUIT HUB LOCATION	
ABB Phoenix, AZ OTSG9000 - Turnstiles Two ADA Lanes Conduit Hub Installation Location	
DRAWING:	
ABB PHOENIX AZ OTSG9000 TURNSTILES CONDUIT HUB DET	
DATE:	07-24-25
PAGE:	1 OF 1

Raco 1712 Rigid/IMC
Conduit Hub, 3" Trade Size

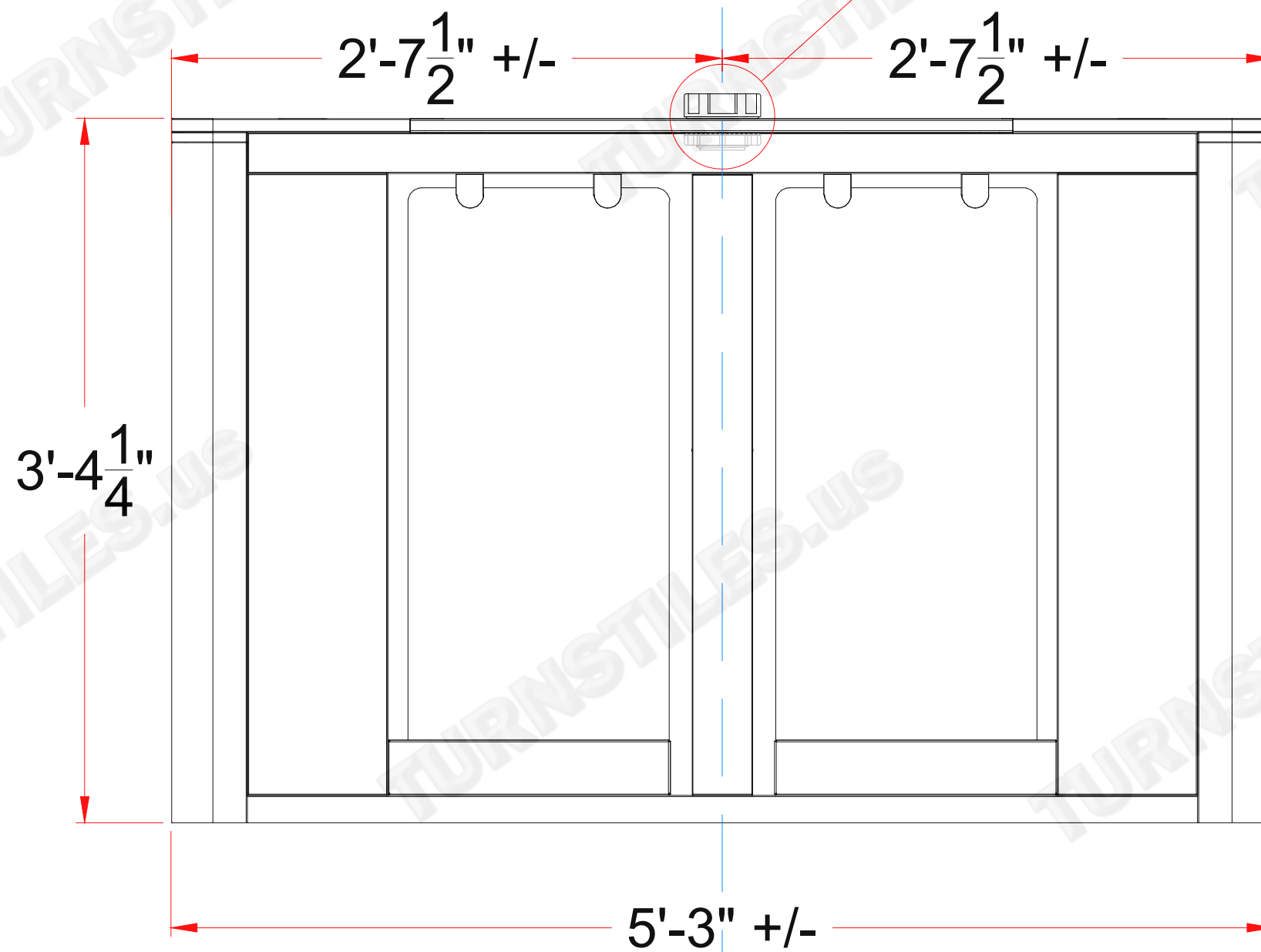

SIDE ELEVATION

Raco 1712 Rigid/IMC
Conduit Hub, 3" Trade Size

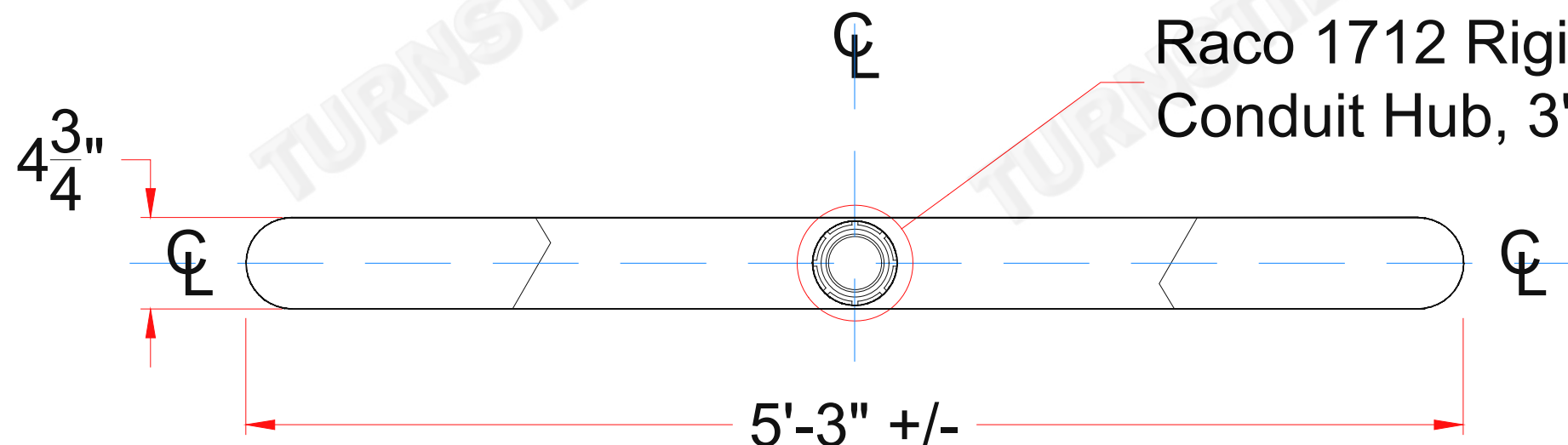

TOP VIEW

CL = CABINET
CENTER LINES

*** Required:
Verification of diameter
before cutting or drilling

Cut-out Ø (3", 3 1/16") ***